

FOR LEASE ±10,388 SF

17352 MURPHY AVENUE, SUITE B

Irvine, CA 92614



PROPERTY FEATURES

- + ±10,388 SF with ±1,720 SF of Office
- + One (1) Ground Level Door
- + Possible Yard Area
- + ±18' Minimum Warehouse Clearance
- + 2:1,000 Parking Ratio
- + Fully Sprinklered
- + Drive Around Building
- + Building and Monument Signage Available
- + Excellent Access to the 55, 405 Freeways and the 73 Toll Road



FOR LEASE
±10,388 SF

17352
MURPHY AVENUE, SUITE B
Irvine, CA 92614



FLOOR/SITE PLAN

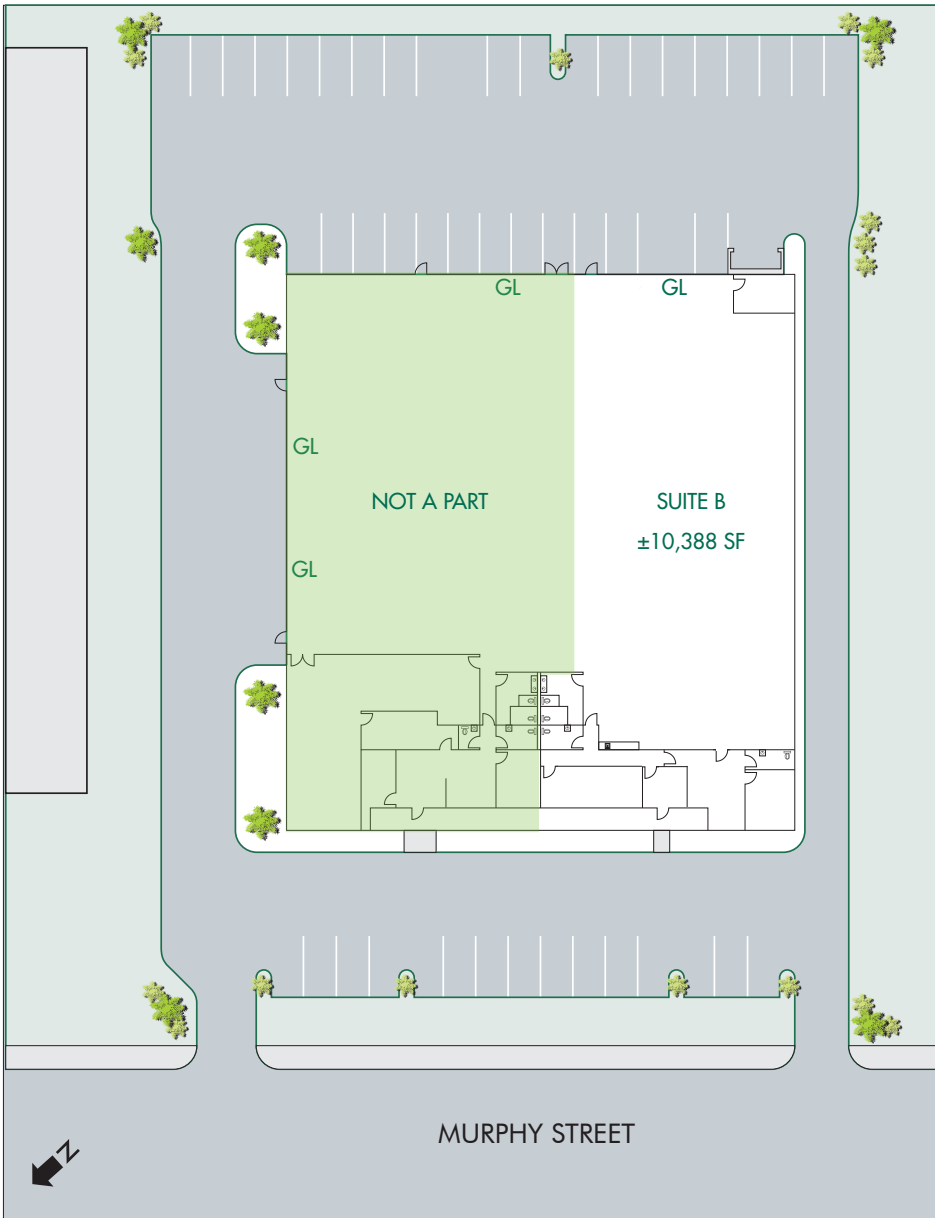

FOR LEASE
±10,388 SF

**17352
MURPHY AVENUE, SUITE B**
Irvine, CA 92614

